

DONKIN CAST IRON SOFTSEAL VALVE, PN7

555/300-002

The Series 555/300-002 Softseal valve is a cast iron double-faced, resilient seat, internal screw, clear bore wedge gate valve. It is designed primarily for the isolation of sewage gas and wet/dirty gases.

Features:

- Full double block and bleed with pressure relieving plug.
- Soft seal positive shut off, metal to metal secondary seal.
- Maintenance free.
- Kitemark approved for GIS/V7 Part 1.
- Self supporting "flange feet" for ease of installation and stockholding.
- Fasteners covered in hot melt EVA co-polymer to provide enhanced corrosion protection and anti tamper feature.
- Profiled 'O' ring body/bonnet joint.
- Suitable for under pressure drilling and tapping operations.
- Suitable for end of line service.
- Integral lifting lugs on all sizes.
- EN1092 PN16 flanges.

Options:

- Can be supplied with cast iron handwheel.
- Special seals available - dependant on type of gas.
- Alternative flange drillings.



KM518241
GIS/V7-1



The designs, materials and specifications shown are subject to change without notice due to our continuing programme of product development.

DONKIN CAST IRON SOFTSEAL VALVE, PN7

555/300-002

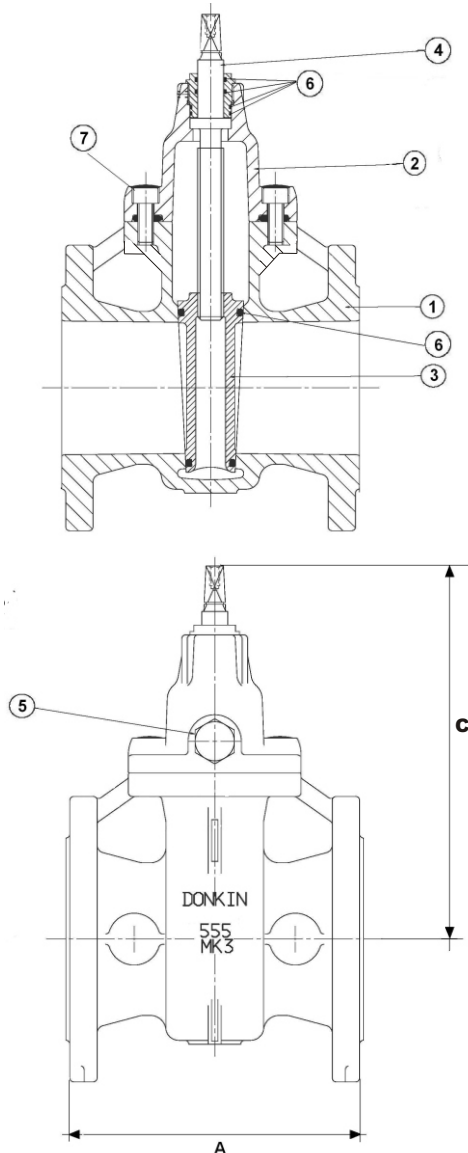

SERVICE CONDITIONS

Pressure range: 7 Bar (100psig) as standard.
Temperature range: -10°C to +100°C.

APPLICABLE STANDARDS

GIS/V7 Part 1, EN12266.

MATERIALS OF CONSTRUCTION

No.	DESCRIPTION	MATERIAL
1	Body	Cast iron. EN 1561 - GJL 250.
2	Bonnet	Cast iron. EN 1561 - GJL 250.
3	Wedge Gate	Cast iron. EN 1561 - GJL 250.
4	Spindle	Standard: Stainless steel. EN10088 X8CrNc518-9 (303531).
5	Pressure relief plug	Carbon steel.
6	Body/ bonnet, gate and spindle seals	Viton.
7	Fastenings	Grade 8.8 Steel FZB. BS EN ISO 4762.
	Handwheel	Standard: Cast iron EN 1561 GJL 250.

GENERAL NOTE

It is important, when installing any valve, that pipeline stresses are kept to a minimum and no undue external forces are placed on the valve connections. The Softseal range of valves are also manufactured in ductile iron, steel and also with P.E tails. Standard flanges are PN16, ASA 150 and other standards available.

DIMENSIONS (mm) & WEIGHTS

Size	A	Pressure relief plug	C	Handwheel Diameter	Approx turns to close	Nett Weight Kg
80	203	Rp 3/4	296	200	13	23
100	229	Rp 3/4	334	200	15 1/2	28
150	267	Rp 3/4	446	300	15	62
200	292	Rp 3/4	529	300	19 1/2	90
250	330	Rp 3/4	665	400	25	182
300	356	Rp 3/4	730	400	27	228

Note: 50mm option is model 555/200



AVK UK Limited

Northampton Office
8 Rushmills, Northampton,
NN 4 7YB England, UK.
Tel.: +44 (0) 1604 601188
Fax.: +44 (0) 1604 604818

Chesterfield Office
Colliery Close, Ireland Ind. Est., Staveley,
Chesterfield, S43 3FH England, UK.
Tel.: +44 (0) 1246 479100
Fax.: +44 (0) 1246 479200

www.avkuk.co.uk